

PROPOSED EXTENSION & RE-ORDERING

- EXTENSION (63sq.m) - KITCHEN
- MEETING ROOM/SUNDAY SCHOOL
- TWO WCs (ONE ACCESSIBLE)
- STORAGE
- NEW OAK BOARDED FLOOR, RAISED 100mm IN NAVE AND NORTH & SOUTH AISLES
- NEW HEATING & LIGHTING
- NEW CHAIRS (STACKABLE, FLEXIBLE LAYOUT)
- LEVEL ACCESS THROUGHOUT (EXCEPT CHANCEL)
- CRECHE/SMALL MEETING ROOM AT BASE OF TOWER
- ADDITIONAL STORAGE
- GLASS DOORS TO SOUTH PORCH ENTRANCE
- NEW DAIS FOR NAVE ALTAR & REMOVABLE RAILS
- STAIR TO 1st FLOOR GALLERY FOR CHOIR & SOUND DESK

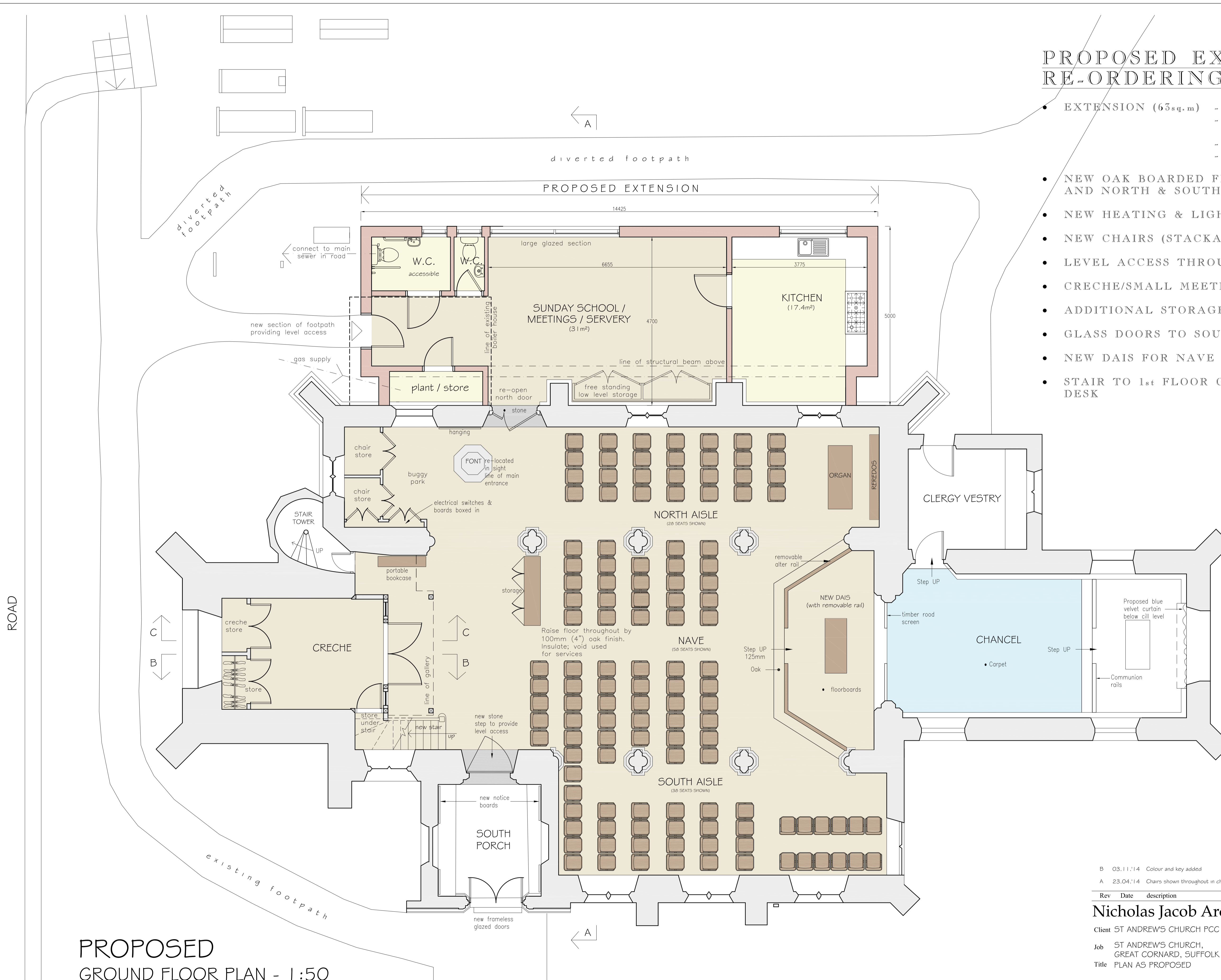

PROPOSED
GROUND FLOOR PLAN - 1:50

Rev	Date	Description	Drawn
B	03.11.14	Colour and key added	RJS
A	23.04.14	Chairs shown throughout in church. Room names in Tower updated.	PJ

Nicholas Jacob Architects
 89 Berners Street
 Ipswich
 Suffolk
 IP1 3LN
 Tel: 01473 221150
 Fax: 01473 255550
 Nicholas.Jacob@NJArchitects.co.uk

Client: ST ANDREW'S CHURCH PCC
 Job: ST ANDREW'S CHURCH, GREAT CORNARD, SUFFOLK
 Title: PLAN AS PROPOSED

Drawn: PJ
 Checked: PJ
 Date: JAN 2014
 Scale: 1:50 @ A1

011707 B

Do Not Scale. Check all dimensions on site and report discrepancies. ©All rights reserved